

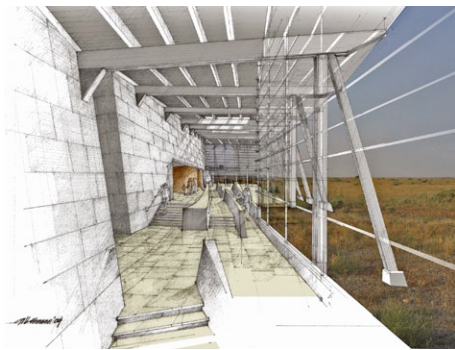

HANFORD REACH INTERPRETIVE CENTER

RICHLAND, WASHINGTON

VARIOUS FEDERAL STATE AND LOCAL GOVERNMENTS
IN PARTNERSHIP WITH COMMUNITY ORGANIZATIONS

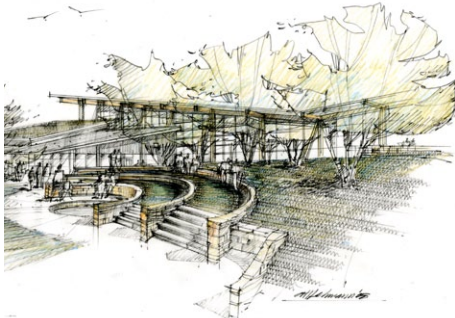

This new visitor center, known as “The Reach,” will be a gathering place to learn about the geological, ecological, and cultural history of the Hanford Reach National Monument and the greater Columbia River Basin.

Located near the confluence of the Snake and Yakima Rivers, The Reach will symbolize not only the coming together of water, but also diverse communities, cultures, species, and viewpoints. Unlike any other facility in the region, The Reach will provide a place where our children and grandchildren can learn about and celebrate the big land, big rivers, and big ideas that shaped our history and will shape our future. It will have a lasting impact on future generations.

FACTS

- 61,000 sq. ft. visitor center
- Immersion theater
- Temporary and permanent exhibition galleries
- Indoor and outdoor classrooms
- Native plant interpretive gardens
- Café
- Gift shop
- Phase I (site work) in construction

BENEFITS

- Inspiration for environmental and cultural stewardship
- Collaboration among diverse stakeholders

JONES  JONES

ARCHITECTS
LANDSCAPE ARCHITECTS
PLANNERS