



NOYO CENTER FOR SCIENCE AND EDUCATION

FORT BRAGG, CALIFORNIA

WITH BAUER & WILEY ARCHITECTS

CITY OF FORT BRAGG

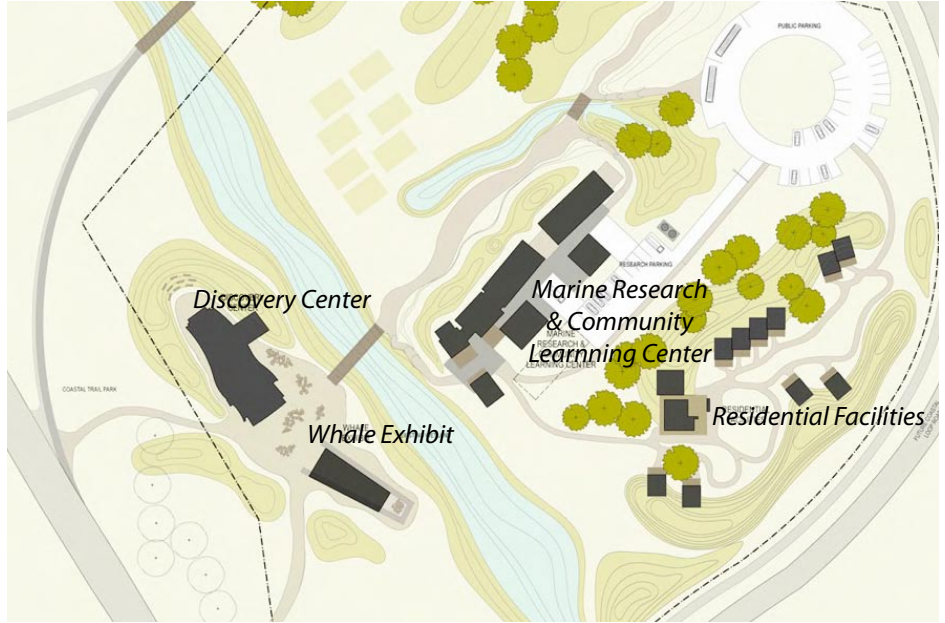

FACTS

- 25,000 SF facility
- Marine science center for Sonoma State University
- Lodging
- Interpretive center with aquarium, tidal exhibit and display of 72-foot articulated blue whale skeleton
- Connection to Coastal Trail
- Projected 60,000-80,000 visitors annually
- Integrated landscape and buildings
- Planned as net-zero energy and zero carbon footprint

BENEFITS

- Restoration of native coastal prairie and forest habitat
- Reconnecting Fort Bragg community to coast
- Marine & coastal research and education
- Inspiration for coastal stewardship
- Growing a green Fort Bragg economy

The Noyo Center will be a first-rate marine research, learning, and interpretive complex at the Fort Bragg headlands. The facility — comprised of a Marine Research and Community Learning Center — will advance marine and coastal research, public education, and spearhead the restoration of Native coastal prairie on a degraded industrial site.

Wind and water, including the existing wetland, are central elements of the design, shaping the site, the facilities, and visitor experience. A bridge over the wetland connects public areas with private research zones, and forms the primary interpretive spine of the campus. Buildings are nestled in berms covered with coastal prairie plants, protecting structures from the harsh environment while framing expansive ocean views.

The result of collaboration between the City of Ft. Bragg, Sonoma State University, the Coastal Conservancy, the community, and the design team,

this project is a forerunner in the entire restoration and sustainable redevelopment of a 320-acre abandoned mill site.

The first phase of development will include the educational Discovery Center, an aquarium, and marine science laboratories. The second phase will add additional research facilities, resident lodging, and exhibit space for a blue whale skeleton.

People's Choice Award (unbuilt category), 2010
American Institute of Architects, Redwood Empire Chapter

JONES & JONES

ARCHITECTS
 LANDSCAPE ARCHITECTS
 PLANNERS